

GHS SERIES Flexible Seal HEAVY DUTY STANDARD STEEL ROTARY GEAR PUMP

This heavy duty series pump is ideal for refining, petrochemical and applications requiring extra strength or shock resistance. The steel construction conforms to ASTM designation A216 Grade WCB. Superior rotor shaft support and an integral, maintenance-free radial/thrust bearing, reduce deflection and wear.

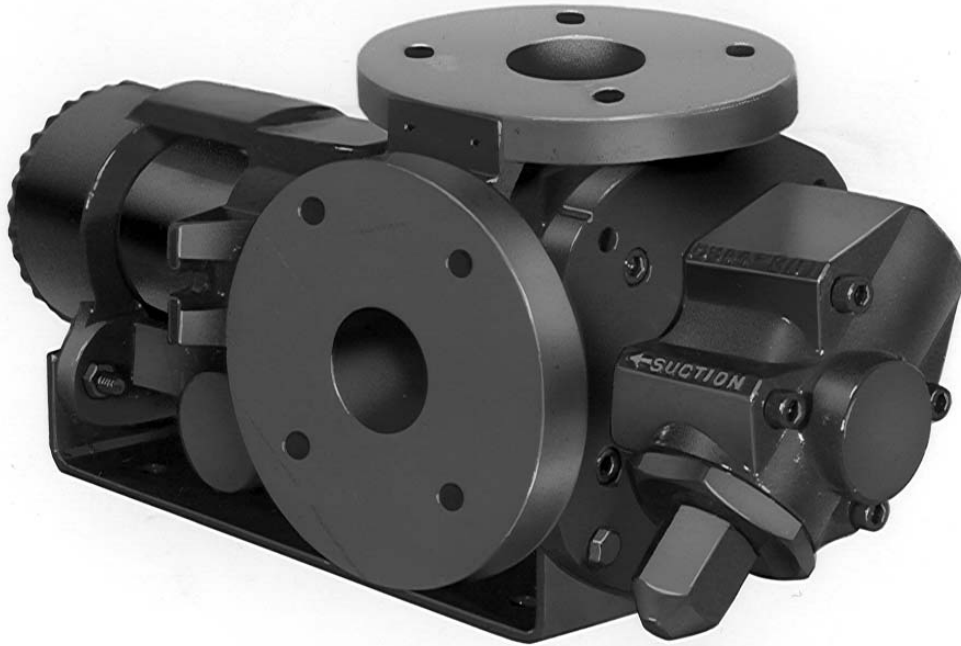

The GHS steel series is designed for applications in the operating ranges noted below. These units are available with head and backhead jackets for temperature control, carbon graphite bushings for low viscosity liquids, silicon carbide bushings for wear resistance, and numerous shaft seal options described on the following pages.

FEATURES

400 PSI CAPABILITY
BALL BEARING THRUST CONTROL
ROTOR END CLEARANCE EXTERNALLY ADJUSTABLE
HIGH STRENGTH, COMPUTER PROFILED GEARING FOR QUIET OPERATION
MULTIPLE PORT POSITIONS
FLEXIBLE SEAL DESIGN ALLOWS FOR A VARIETY OF INDUSTRIAL STANDARD SEALS OR PACKING
INTERNAL SEAL VENT

OPERATING RANGE

CAPACITY (GPM) : (3 TO 295)
 [LPM] : [11 TO 1116]

PRESSURE (PSI) : [0 TO 300]
 [BAR] : [0 TO 21]

VISCOSITY (SSU) : (28 TO 2,000,000)
 [cSt] : [1 TO 440,000]

TEMPERATURE (F) : (-20° TO 675°)
 [C] : [-29° TO 358°]

APPLICATIONS

USE WITH ANY CLEAN LIQUID COMPATIBLE WITH IRON/STEEL

- ★ BOOSTER SERVICE
- ★ CIRCULATING
- ★ FILTERING
- ★ LUBRICATING
- ★ TRANSFERRING

EXTERIOR	BACKHD	ROTOR & IDLER	HOUSING PORTS	BUSHING	IDLER PIN	SHAFT	SHAFT SEALING		ROTA-TION	INTERNAL RELIEF VALVE	
							MECH. SEAL ●	PACKING ■		MATERIAL	SETTING
STEEL ③	DUCTILE IRON	HIGH STRENGTH IRON	150# FLG GHC 180° GHS 90°	BRONZE	HARD STEEL	STEEL	VITON	CARBON FIBER	C.W.	STEEL	75 PSI [5 BAR]

Standard Models

G H C 3 JG 32 - B
G H S 3 JG 32 - B
 | | | | | | | | | | | |
 GEAR DUTY DESIGN PORT SIZE HYDRAULIC SEAL STYLE

MODEL NUMBER		NOM. CAPACITY - SPEED				MAXIMUM				SHIPPING DATA		
		MAXIMUM		ALTERNATIVE		DIFF. PRESSURE - PSI [BAR]			TEMP	Wt.	Vol.	
		GPM [LPM]	RPM 60 Hz [50 HZ]	GPM [LPM]	RPM 60 Hz [50 HZ]	BELOW 38 SSU [4 cSt]	38 TO 100 SSU [21 cSt]	100 TO 250,000 SSU [55,000 cSt]	°F [°C]			
GHC	GHS							LBS [KG]	CU. FT.			
GHC 1 DC32-B ① ● †		9 [28]		6 [19]						39 [17,7]	0.6	
GHC 1 DE32-B ① ● †		11 [35]		7 [22]						39 [17,7]	0.6	
GHC 1-1/2 GC32-B ● †	GHS 1-1/2 GC32-B ● † GHS 1-1/2 GC38-B ■ †	16 [50]	1750 [1460]	10 [32]	1150 [960]			300 [21]	GHC ●	71 [32,2]	2.9	
GHC 1-1/2 GF32-B ● †	GHS 1-1/2 GF32-B ● † GHS 1-1/2 GF38-B ■ †	23 [73]		15 [47]						350 [177]	71 [32,2]	2.9
GHC 1-1/2 GH32-B ● †	GHS 1-1/2 GH32-B ● † GHS 1-1/2 GH38-B ■ †	31 [98]		20 [63]						GHS ●	71 [32,2]	2.9
GHC 1-1/2 GJ32-B ② ● †	GHS 1-1/2 GJ32-B ② ● † GHS 1-1/2 GJ38-B ② ■ †	38 [120]		25 [79]				100 [7]	150 [10]	400 [204]	71 [32,2]	2.9
GHC 3 JG32-B ● †	GHS 3 JG32-B ● † GHS 3 JG38-B ■ †	40 [126]	1150 [960]	30 [95]	870 [725]				500 [260]	154 [69,8]	5.3	
GHC 3 JJ32-B ● †	GHS 3 JJ32-B ● † GHS 3 JJ38-B ■ †	56 [177]		36 [114]						300 [21]	154 [69,8]	5.3
GHC 3 JL32-B ● †	GHS 3 JL32-B ● † GHS 3 JL38-B ■ †	77 [243]		58 [183]							154 [69,8]	5.3
GHC 3 JP32-B ② ● †	GHS 3 JP32-B ② ● † GHS 3 JP38-B ② ■ †	107 [338]		81 [256]						200 [14]		154 [69,8]

STANDARD MODELS
CONTINUED

NOTE: RECOMMENDED PORT SIZES ARE SHOWN IN **BOLDFACE**. EXAMPLE: **GHC 3 JG32-B, GHS 3 JG32-B**

- MECHANICAL SEAL
- LIPSEAL/PACKING
- † PORTS ARE COMPATIBLE WITH 150# ANSI FLANGES. ALL OTHER PORTS ARE TAPPED NPT FOR ANSI PIPE. OPTIONAL [DIN] FLANGES OR TAPPED [BSP] PORTS AVAILABLE FOR EXPORT MARKET.

- ① 3450 [2875] RPM PERMISSIBLE TO 1,000 SSU [220 cSt] AND 100 PSI [7 BAR]
- ② PUMP LIMITED TO 200 PSI MAXIMUM PRESSURE.
- ③ REFER TO REFERENCE SECTION FOR SPECIFIC CONSTRUCTION DETAILS.

THE GORMAN-RUPP COMPANY • MANSFIELD, OHIO
GORMAN-RUPP OF CANADA LIMITED • ST. THOMAS, ONTARIO, CANADA

MODEL NUMBER		NOM. CAPACITY - SPEED				MAXIMUM				SHIPPING DATA	
		MAXIMUM		ALTERNATIVE		DIFF. PRESSURE - PSI [BAR]			TEMP.	Wt.	Vol.
		GPM	RPM	GPM	RPM	BELOW	38 TO	100 TO	° F	LBS	CU.
GHC	GHS	[LPM]	60 Hz	[LPM]	60 Hz	38 SSU	100 SSU	250,000 SSU	[° C]	[KG]	FT.
			[50 HZ]		[50 HZ]	[4 cSt]	[21 cSt]	[55,000 cSt]			
	GHS 2 NK32-B ● † GHS 2 NK38-B ■ †	99 [375]	960 [960]	60 [189]	580 [480]			300 [21]		200	5.3
										[90,7]	
	GHS 3 NK32-B ● † GHS 3 NK38-B ■ †	132 [500]	960 [960]	80 [252]	580 [480]			300 [21]		200	5.3
										[90,7]	
	GHS 2 NM32-B ● † GHS 2 NM38-B ■ †	165 [624]	720 [600]	99 [312]	480 [400]	100 [7]	150 [10]	300 [21]		200	5.3
										[90,7]	
	GHS 3 NP32-B ① ● † GHS 3 NP38-B ① ■ †	172 [542]	720 [600]	115 [362]	480 [400]	100 [7]	150 [10]	300 [21]	GHS ● 400 [204]	200	5.3
										[90,7]	
	GHS 2-1/2 RM32-B ● † GHS 2-1/2 RM38-B ■ †	215 [678]	720 [600]	143 [451]	480 [400]	100 [7]	150 [10]	300 [21]	GHS ● 400 [204]	302	10.7
										[136,9]	
	GHS 3 RM32-B ● † GHS 3 RM38-B ■ †	255 [804]	720 [600]	170 [536]	480 [400]	100 [7]	150 [10]	300 [21]	GHS ● 400 [204]	302	10.7
										[136,9]	
	GHS 4 RM32-B ● † GHS 4 RM38-B ■ †	295 [930]	720 [600]	196 [618]	480 [400]	100 [7]	150 [10]	300 [21]	GHS ● 400 [204]	302	10.7
										[136,9]	
	GHS 2-1/2 RP32-B ● † GHS 2-1/2 RP38-B ■ †	255 [804]	720 [600]	170 [536]	480 [400]	100 [7]	150 [10]	300 [21]	GHS ● 400 [204]	302	10.7
										[136,9]	
	GHS 3 RP32-B ● † GHS 3 RP38-B ■ †	295 [930]	720 [600]	196 [618]	480 [400]	100 [7]	150 [10]	300 [21]	GHS ● 400 [204]	302	10.7
										[136,9]	
	GHS 4 RP32-B ● † GHS 4 RP38-B ■ †	255 [804]	720 [600]	170 [536]	480 [400]	100 [7]	150 [10]	300 [21]	GHS ● 400 [204]	302	10.7
										[136,9]	
	GHS 3 RR32-B ● † GHS 3 RR38-B ■ †	295 [930]	720 [600]	196 [618]	480 [400]	100 [7]	150 [10]	300 [21]	GHS ● 400 [204]	302	10.7
										[136,9]	
	GHS 4 RR32-B ● † GHS 4 RR38-B ■ †	295 [930]	720 [600]	196 [618]	480 [400]	100 [7]	150 [10]	300 [21]	GHS ● 400 [204]	302	10.7
										[136,9]	
	GHS 3 RS32-B ① ● † GHS 3 RS38-B ① ■ †	295 [930]	720 [600]	196 [618]	480 [400]	100 [7]	150 [10]	300 [21]	GHS ● 400 [204]	302	10.7
										[136,9]	
	GHS 4 RS32-B ① ● † GHS 4 RS38-B ① ■ †	295 [930]	720 [600]	196 [618]	480 [400]	100 [7]	150 [10]	300 [21]	GHS ● 400 [204]	302	10.7
										[136,9]	

STANDARD MODELS CONTINUED

- MECHANICAL SEAL
- LIPSEAL/PACKING
- † PORTS ARE COMPATIBLE WITH 150# ANSI FLANGES. ALL OTHER PORTS ARE TAPPED NPT FOR ANSI PIPE. OPTIONAL [DIN] FLANGES OR TAPPED [BSP] PORTS AVAILABLE FOR EXPORT MARKET.

① PUMP LIMITED TO 200 PSI MAXIMUM PRESSURE.

THE GORMAN-RUPP COMPANY • MANSFIELD, OHIO
GORMAN-RUPP OF CANADA LIMITED • ST. THOMAS, ONTARIO, CANADA

APPLICATION RECOMMENDATIONS:		
APPLICATION	OPTIONS REQUIRED (Select One From Each Row)	OPERATING LIMITATIONS
GHS ONLY HIGH TEMPERATURE	25U, 25V, OR 25W 35J – 35M (AS REQ'D) 40M, 40W 61H, OR 65Q 70K	TEMPERATURE: 675° F MAX. PRESSURE: 200 PSI MAX.
ASPHALT	35J–35M (AS REQ'D) 40M, 40W, 40G 41R, 41W 65S 70, 70K, 71K	TEMPERATURE:500° MAX.
JACKETED	40G, 40J, 40K, 40W, 41U, 41W	LIMIT JACKET PRESSURE TO 150 PSIG

NOTE: PROPER PUMP APPLICATION REQUIRES CONSIDERATION OF ADDITIONAL FACTORS. PLEASE REVIEW APPLICATION GUIDE IN SECTION 500 OR CONSULT THE FACTORY.

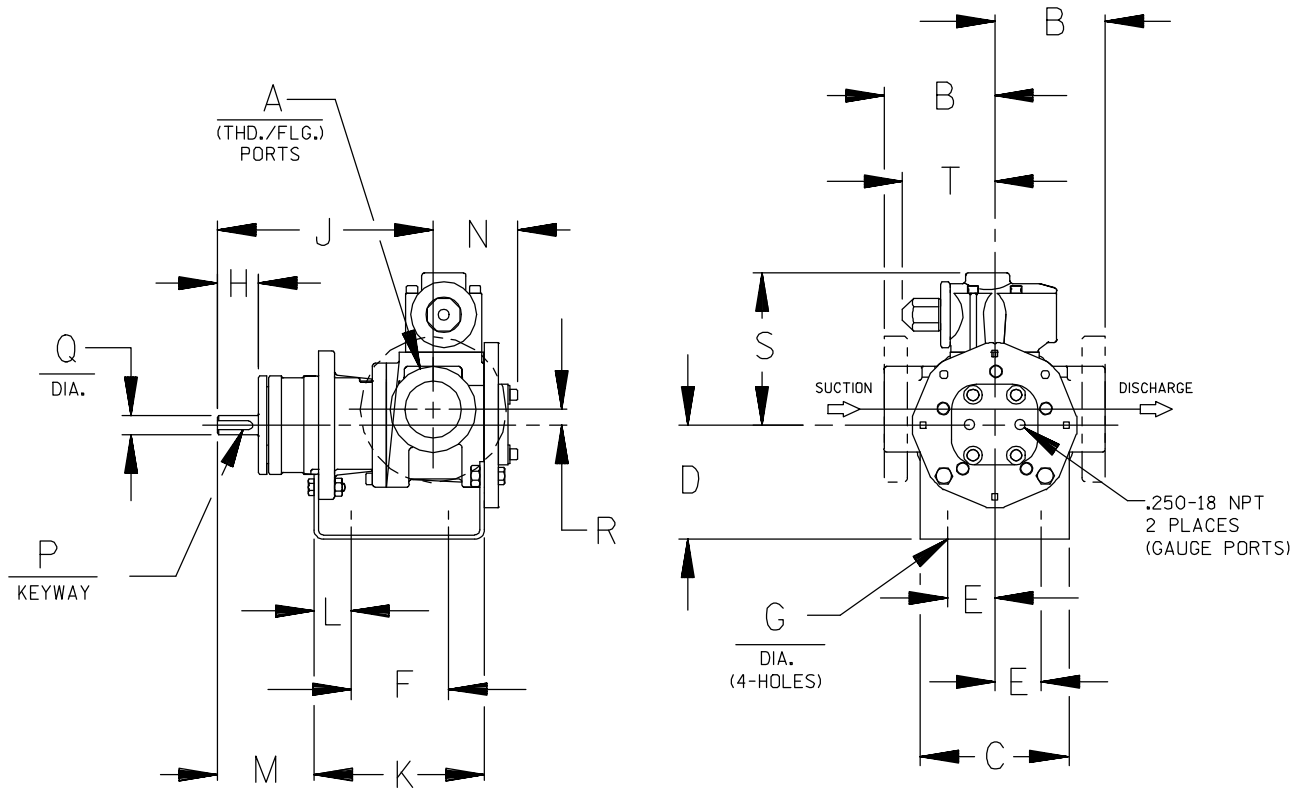

CAD FILE NO.: 16458D

MODEL NUMBERS	PUMP DIMENSIONS - INCHES [MILLIMETERS]																	
	A	B	C	D	E	F	G	H	J	K	L	M	N	P	Q	R	S	T
GHC D	1"	4.00 † [102]	4.00 [102]	3.50* [89] 4.50 [114] 5.25 [133]	1.62 [41]	3.12 [79]	.41 [10]	1.16 [30]	6.19 [157]	5.04 [128]	.76 [19]	2.62 [66]	2.74 [70]	.12 [3] x .75 [19]	.50 [13]	.62 [16]	5.19 [132]	3.58 [91]
GHC G	1-1/2"	4.00 † [102]	5.88 [149]	3.50* [89] 4.50 [114] 5.25 [133] 6.25 [159]	1.62 [41]	4.00 [102]	.41 [10]	1.62 [41]	8.50 [216]	6.71 [170]	1.06 [27]	3.82 [97]	3.35 [85]	.19 [5] x 1.25 [32]	.75 [19]	.62 [16]	6.00 [152]	3.62 [92]
GHC J	3"	6.00* [152] † 6.31 † [160]	6.88 [175]	4.50 [114] 5.25* [133] 6.25 [159] 7.00 [178] 8.00 [203]	2.88 [73]	4.25 [108]	.44 [11]	2.50 [64]	12.12 [308]	9.75 [248]	1.75 [44]	5.50 [140]	4.66 [118]	.25 [6] x 2.00 [51]	1.00 [25]	1.12 [28]	9.06 [230]	6.75 [171]

* STANDARD DIMENSION
 PORTS ARE COMPATIBLE WITH 150# OR 300# ANSISTEEL FLANGES. ALL OTHER PORTS ARE TAPPED NPT
 † FOR ANSIPIPE. OPTIONAL [DIN FLANGES OR TAPPED [BSP] PORTS AVAILABLE FOR EXPORT MARKET.
 NPT FOR ANSIPIPE. OPTIONAL (DIN) FLANGES OR TAPPED (BSP) PORTS AVAILABLE FOR EXPORT MARKET.
 ‡ 90° HOUSING

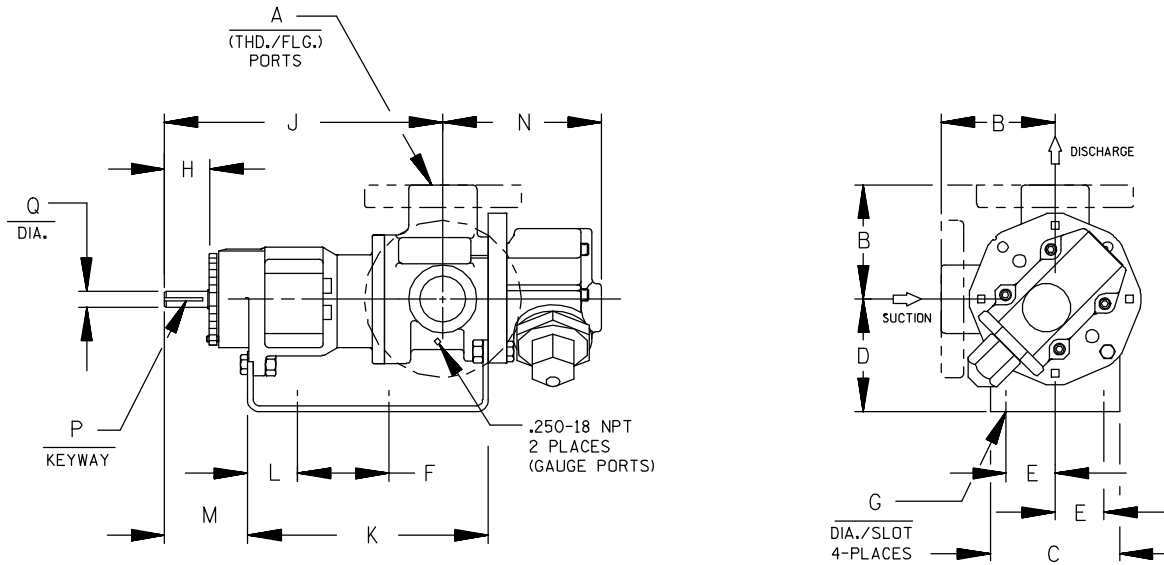

CAD FILE NO.: 16669F

MODEL NUMBERS	PUMP DIMENSIONS - INCHES [MILLIMETERS]														
	A	B	C	D	E	F	G	H	J	K	L	M	N	P	Q
GHS G	1-1/2"	4.00 [102]	4.88 [124]	3.50* [89] 4.50 [114] 5.25 [133] 6.25 [159]	1.62 [41]	8.00 [203]	.41 [10]	1.62 [41]	12.06 [306]	10.72 [272]	1.52 [39]	3.35 [85]	5.70 [145]	.19 [5] x 1.25 [32]	.75 [19]
GHS J	3"	6.00† [152] 6.31 [160]	6.88 [175]	5.25* [133] 6.25 [159] 7.00 [178] 8.00 [203]	2.88 [73]	10.00 [254]	.44 [11]	2.50 [64]	15.68 [398]	14.31 [363]	2.77 [70]	4.48 [114]	8.50 [216]	.25 [6] x 2.00 [51]	1.00 [25]
GHS N	2"	5.25* [133] 5.38 [137]	8.00 [203]	4.50 [114] 5.25* [133] 6.25 [159] 7.00 [178] 8.00 [203]	2.88 [73]	10.00 [254]	.44 [11]	2.58 [66]	16.37 [416]	15.14 [385]	2.69 [68]	4.56 [116]	7.59 [193]	.25 [6] x 2.00 [51]	1.12 [32]
	3"	7.19 [183]											8.72 [221] *		
GHS R	2-1/2"													.38 [10] x 1.88 [48]	1.44 [37]
	3"	7.19 [183]	10.50 [267]	7.00 [178]	3.75 [95]	13.75 [349]	.52 [13]	2.25 [57]	17.87 [454]	17.36 [441]	1.80 [46]	4.70 [119]	11.31 [287]		
	4"														

* STANDARD DIMENSION

† PORTS ARE COMPATIBLE WITH 150* OR 300* ANSISTEEL FLANGES. ALL OTHER PORTS ARE TAPPED NPT FOR ANSIPIPE. OPTIONAL (DIN) FLANGES OR TAPPED (BSP) PORTS AVAILABLE FOR EXPORT MARKET.

† 180° HOUSING

GHC/GHS

FOR GHC DRIVE OPTIONS

AND DIMENSIONS

SEE

SECTION 540

FOR GHS DRIVE OPTIONS

AND DIMENSIONS

SEE

SECTION 545



PERFORMANCE CURVES

SPEED VS. CAPACITY/HORSEPOWER

GH

Hydraulic Size

SEC. 500

Page 50

January 2010

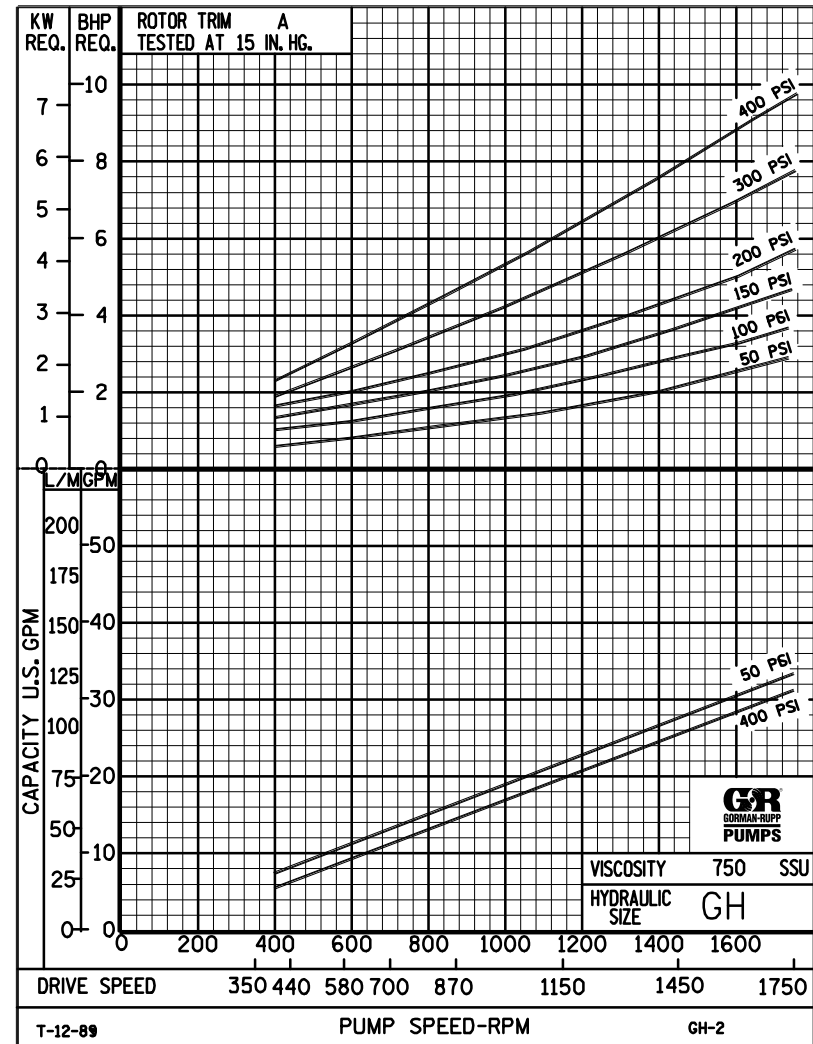
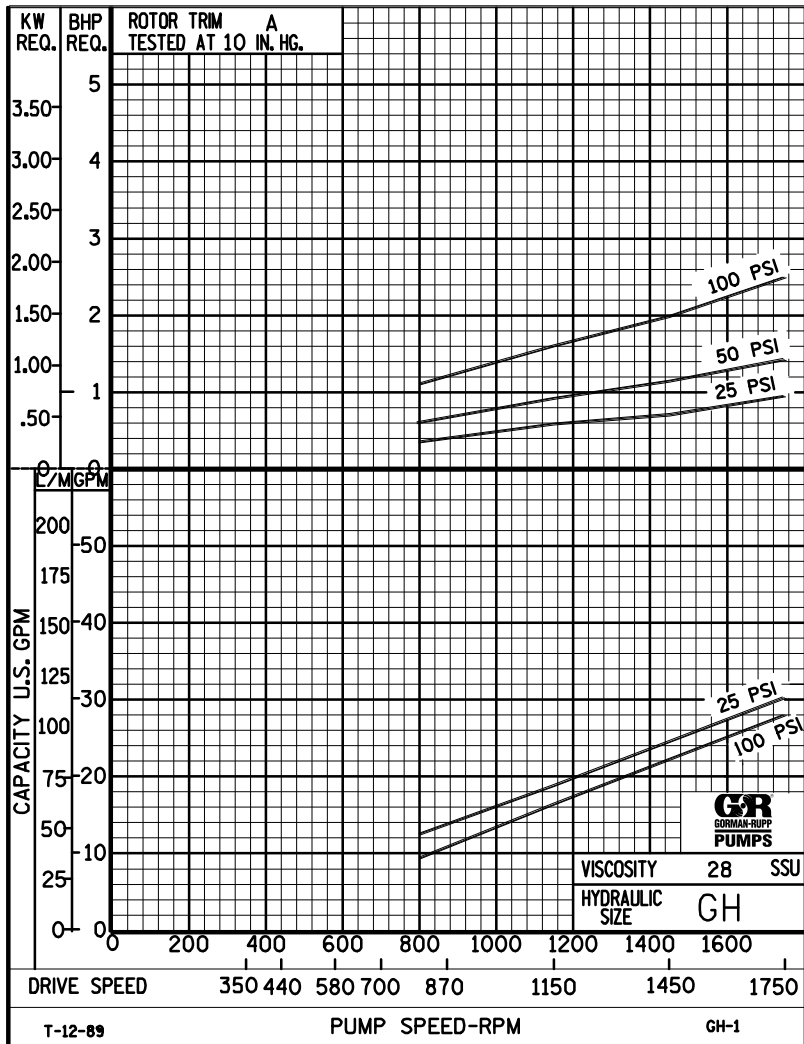

THE GORMAN-RUPP COMPANY • MANSFIELD, OHIO
 GORMAN-RUPP OF CANADA LIMITED • ST. THOMAS, ONTARIO, CANADA

Printed in U.S.A.



PERFORMANCE CURVES

SPEED VS. CAPACITY/HORSEPOWER

GH

Hydraulic Size

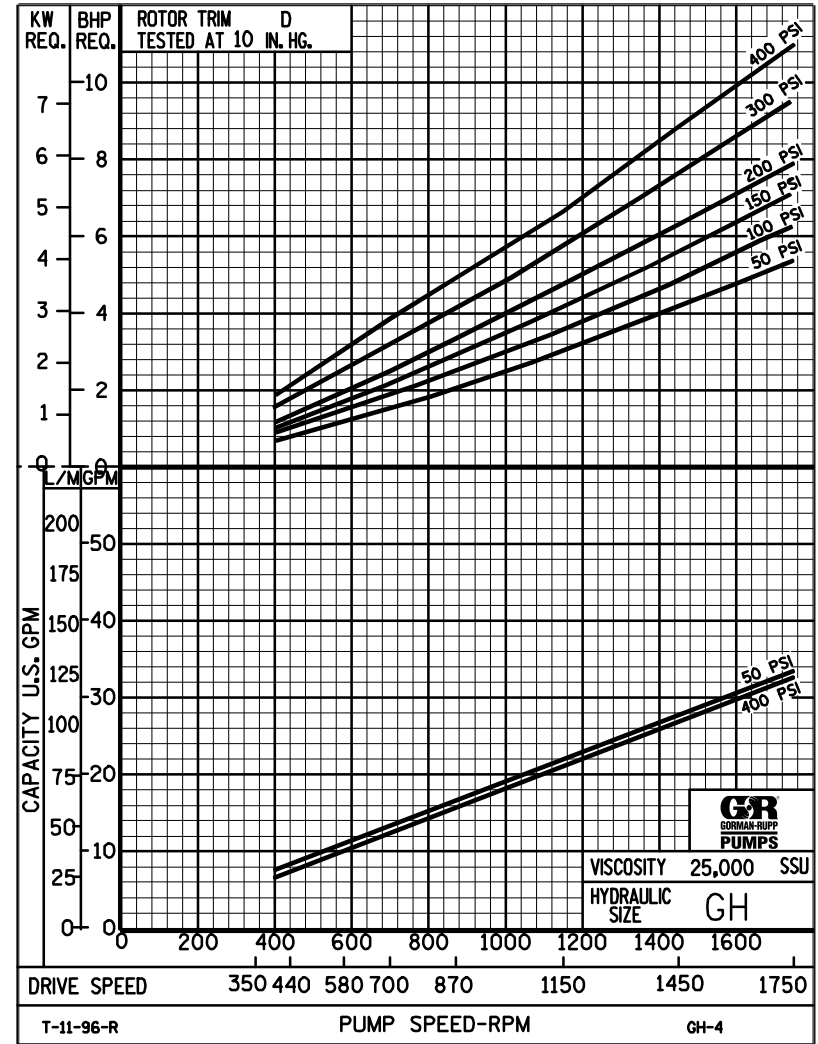
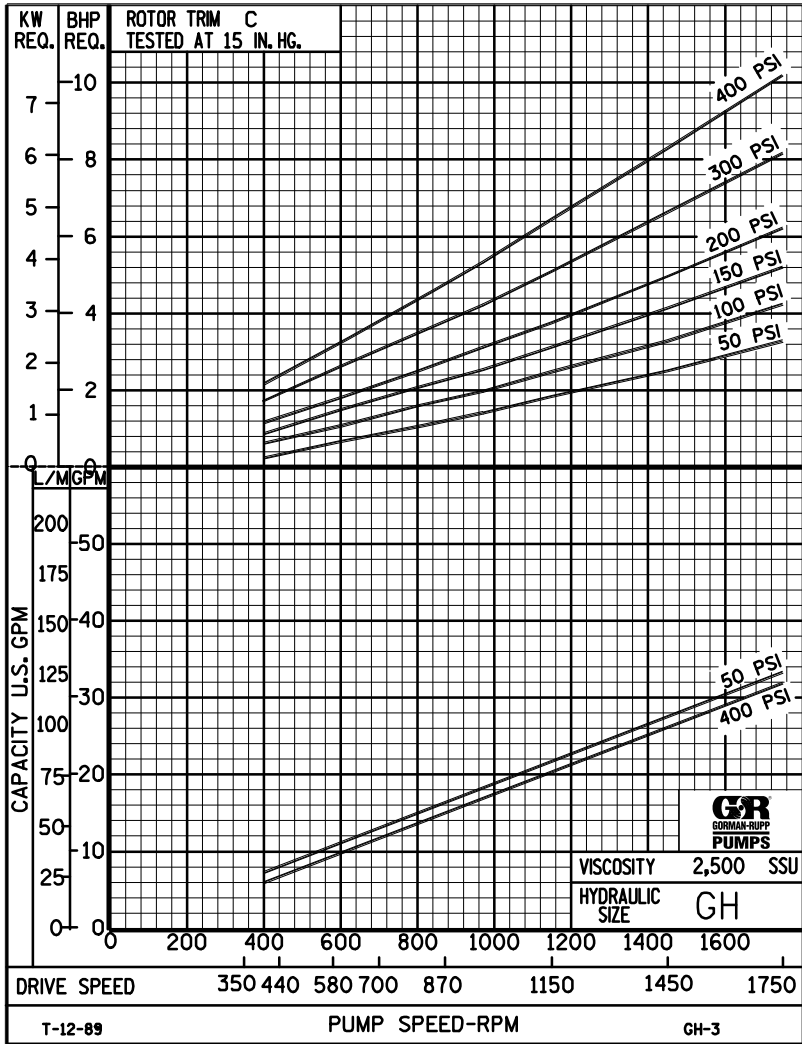

THE GORMAN-RUPP COMPANY • MANSFIELD, OHIO
 GORMAN-RUPP OF CANADA LIMITED • ST. THOMAS, ONTARIO, CANADA



GH

PUMP HYDRAULIC SIZE CHART

SEC. 500

Page 52
January 2010

**31 GPM
1750 RPM**

NOMINAL		ROTOR TRIM	VISCOSITY (SSU)	N.I.P.R. (PSIA)	FRICTION PIPE LOSS (PSI/FT) <small>(Based on Sch 40 Steel Pipe)</small>					FULL BYPASS RELIEF VALVE PRESSURE (PSI)					CAPACITY (GPM) / H.P. REQUIRED								
					PIPE DIAMETER					CRACKING PRESS. (PSI)					DIFFERENTIAL PRESSURE (PSI)								
CAP. GPM	SPEED RPM				3/4"	1"	1 1/4"	1 1/2"	2"	LOW PRES R/V					MEDIUM DUTY AND HEAVY DUTY				HEAVY DUTY ONLY				
										50	75	100	150	200	25	50	75	100	150	200	300	400	
31	1750	STD	28	4.2	.01	.01	.01	.01	.01	68	97	126			30	29	28	28					
			32		.61	.19	.05	.03	.01	68	97	126			.95	1.4	2.0	2.5					
			38	4.2	.78	.25	.07	.03	.01	68	97	126	176			31	30	29	29	28			
			50		.93	.30	.08	.04	.01	68	97	126	176			1.2	1.8	2.5	2.7	3.9			
			70	4.2	1.02	.35	.09	.05	.02	70	99	128	176	230		32	31	31	30	29	29		
			100		1.22	.39	.11	.05	.02	70	99	128	176	230		1.4	2.0	2.6	3.0	4.2	5.0		
			150	4.2	1.35	.44	.12	.06	.02	72	101	130	176	232		32	32	32	31	31	30	29	28
			200		1.58	.52	.13	.07	.03	72	101	130	176	232		1.6	2.3	2.8	3.3	4.4	5.2	7.3	9.3
			300	4.2	1.80	.61	.16	.08	.03	72	101	130	177	234		33	32	32	32	31	31	30	30
		500		1.98	.75	.25	.14	.05	72	101	130	177	234		1.9	2.8	3.1	3.7	4.8	5.6	7.5	9.6	
		750	4.2	2.97	1.13	.38	.21	.08	74	102	132	177	235		33	33	33	33	32	32	31	30	
		1,000		3.96	1.51	.51	.27	.10	74	102	132	177	235		2.0	3.0	3.5	3.8	5.0	5.8	7.7	9.8	
		2,000	5.5	7.91	3.01	1.00	.54	.20	76	103	133	178	238		33	33	33	33	33	32	32	31	
		3,500		13.9	5.27	1.76	.95	.35	76	103	133	178	238		2.2	3.3	4.0	4.5	5.5	6.5	8.4	11	
		5,000	6.3	20.0	7.53	2.52	1.36	.50	80	105	137	180	240		33	33	33	33	33	32	32	31	
		7,500		29.7	11.3	3.77	2.04	.75	80	105	137	180	240		2.9	4.4	5.0	5.4	6.4	7.3	9.2	11.0	
		10,000	7.1	39.6	15.1	5.03	2.71	1.00	84	109	140	182	242		33	33	33	33	33	32	32	32	
		15,000		59.3	22.6	7.54	4.07	1.50	84	109	140	182	242		3.7	5.5	6.0	6.6	7.6	8.5	10	12	
20,000	7.8	79.1	30.1	10.1	5.43	2.00	88	113	144	184	244		33	33	33	33	33	32	32	32			
25,000		98.9	37.6	12.6	6.78	2.50	88	113	144	184	244		4.7	6.8	7.4	7.9	8.9	9.9	12	14			
50,000																							
75,000																							
100,000																							
150,000																							
200,000																							
250,000																							

(NOTE) For speeds not shown on the pump hydraulic charts, consult factory.

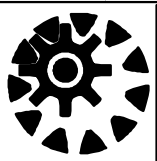

GH

PUMP HYDRAULIC SIZE CHART

SEC. 500

Page 53

January 2010

**20 GPM
1150 RPM**

NOMINAL		ROTOR TRIM	VISCOSITY (SSU)	N.I.P.R. (PSIA)	FRICTION PIPE LOSS (PSI/FT) <small>(Based on Sch 40 Steel Pipe)</small>					FULL BYPASS RELIEF VALVE PRESSURE (PSI)					CAPACITY (GPM) / H.P. REQUIRED										
CAP. GPM	SPEED RPM				PIPE DIAMETER					CRACKING PRESS. (PSI)					DIFFERENTIAL PRESSURE (PSI)										
					3/4"	1"	1 1/4"	1 1/2"	2"	LOW PRES R/V			HI PRES R/V		MEDIUM DUTY AND HEAVY DUTY				HEAVY DUTY ONLY						
							50	75	100	150	200	25	50	75	100	150	200	300	400						
20	1150	STD	28	2.3	.01	.01	.01	.01	.01	63	89	114				18	18	17	16						
			32		.28	.09	.03	.01	.01							.58	.91	1.3	1.6						
			38	2.3	.36	.12	.03	.02	.01	63	89	114	164			19	19	18	17	17					
			50		.44	.14	.04	.02	.01							.66	1.1	1.4	1.7	2.3					
			70	2.3	.49	.15	.04	.02	.01	64	90	116	166	228		20	20	19	18	18	17				
			100		.58	.19	.05	.02	.01							.83	1.2	1.6	1.9	2.6	2.9				
			150	2.3	.64	.21	.06	.03	.01	64	90	116	166	228		21	20	20	19	18	18	17	16		
			200		.68	.25	.08	.04	.02							.91	1.3	1.7	2.0	2.8	3.3	4.5	5.9		
			300	2.3	.78	.30	.10	.06	.02	65	91	120	167	230		21	21	21	20	20	19	19	18		
			500		1.28	.49	.16	.09	.03							1.0	1.5	1.8	2.1	2.9	3.5	4.9	6.0		
		750	2.3	1.92	.73	.24	.13	.05	65	91	120	167	230		22	21	21	21	21	21	20	20			
		1,000		2.55	.97	.33	.18	.07							1.2	1.7	2.2	2.4	3.0	3.6	4.9	6.2			
				"C"	2,000	3.1	5.10	1.94	.65	.35	.13	66	92	121	168	230		22	21	21	21	21	21	21	20
					3,500		8.93	3.40	1.14	.61	.23							1.3	1.9	2.2	2.5	3.1	3.8	5.1	6.4
					5,000	3.6	12.8	4.86	1.62	.88	.32	73	95	123	170	230		22	22	21	21	21	21	21	21
					7,500		19.1	7.29	2.43	1.31	.49							1.7	2.5	2.7	3.0	3.7	4.4	5.6	6.9
					10,000	4.1	25.5	9.71	3.24	1.75	.65	76	97	126	170	230		22	22	22	21	21	21	21	21
					15,000		38.3	14.6	4.86	2.63	.97							2.6	3.0	3.4	3.7	4.4	5.1	6.3	7.6
				"D"	20,000	4.6	51.0	19.4	6.49	3.50	1.29	79	101	128	172	230		22	22	22	21	21	21	21	21
					25,000		63.8	24.3	8.11	4.38	1.61							3.5	3.7	4.1	4.4	5.1	5.7	7.0	8.3
		50,000	7.3		128	48.6	16.2	8.75	3.22	84	107	132	178	235		22	22	22	21	21	21	21	21		
		75,000			191	72.8	24.3	13.1	4.83							5.4	5.7	6.3	6.8	7.4	8.2	9.6	11		
		100,000																							
		150,000																							
		200,000																							
		250,000																							

(NOTE) For speeds not shown on the pump hydraulic charts, consult factory.



GH

PUMP HYDRAULIC SIZE CHART

SEC. 500

Page 54

January 2010

**15 GPM
870 RPM**

NOMINAL		ROTOR TRIM	VISCOSITY (SSU)	N.I.P.R. (PSIA)	FRICTION PIPE LOSS (PSI/FT) <small>(Based on Sch 40 Steel Pipe)</small>					FULL BYPASS RELIEF VALVE PRESSURE (PSI)					CAPACITY (GPM) / H.P. REQUIRED							
CAP. GPM	SPEED RPM				STD	"C"	"D"	PIPE DIAMETER					CRACKING PRESS. (PSI)					DIFFERENTIAL PRESSURE (PSI)				
		3/4"	1"	1 1/4"				1 1/2"	2"	LOW PRES R/V					MEDIUM DUTY AND HEAVY DUTY				HEAVY DUTY ONLY			
										50	75	100	150	200	25	50	75	100	150	200	300	400
15	870	STD	1.6	28	.01	.01	.01	.01	59	86	111			14	13	12	11					
				32	.17	.06	.02	.01	.01					.42	.68	.98	1.2					
			1.6	38	.22	.07	.02	.01	.01	59	86	111	161		14	14	13	12	12			
				50	.27	.09	.03	.01	.01					.48	.74	1.0	1.3	1.8				
			1.6	70	.30	.10	.03	.01	.01	60	87	113	163	215	15	14	14	13	13	13		
				100	.36	.12	.03	.02	.01					.67	.89	1.1	1.4	1.8	2.3			
			1.6	150	.41	.14	.05	.02	.01	60	87	113	163	217	16	15	15	14	14	14	13	12
				200	.46	.18	.06	.03	.01					.74	.96	1.2	1.5	1.9	2.4	3.4	4.3	
			1.6	300	.58	.22	.08	.04	.02	60	87	115	165	219	16	16	15	15	15	15	14	13
				500	.96	.37	.12	.07	.03					.82	1.0	1.3	1.5	2.0	2.5	3.5	4.5	
		1.6	750	1.44	.55	.18	.10	.04	60	87	115	165	222	16	16	16	16	16	15	15	14	
			1,000	1.92	.73	.25	.13	.05					.89	1.1	1.4	1.6	2.1	2.6	3.6	4.6		
		2.2	2,000	3.83	1.46	.49	.26	.10	62	90	115	165	222	16	16	16	16	16	16	15	15	
			3,500	6.70	2.55	.85	.46	.17					1.1	1.3	1.5	1.8	2.3	2.8	3.8	4.8		
		2.7	5,000	9.57	3.64	1.22	.66	.24	65	92	117	167	224	16	16	16	16	16	16	16	15	
			7,500	14.4	5.46	1.83	.99	.36					1.4	1.6	1.9	2.2	2.7	3.2	4.0	5.1		
		3.1	10,000	19.1	7.29	2.43	1.31	.49	68	94	119	169	224	16	16	16	16	16	16	16	16	
			15,000	28.7	10.9	3.65	1.97	.73					1.9	2.1	2.4	2.7	3.2	3.7	4.6	5.6		
		3.5	20,000	38.3	14.6	4.87	2.63	.97	72	97	122	172	224	16	16	16	16	16	16	16	16	
			25,000	47.8	18.2	6.08	3.28	1.21					2.4	2.6	2.9	3.1	3.7	4.2	5.1	6.1		
5.8	50,000	95.7	36.4	12.2	6.56	2.42	77	102	127	177	229	16	16	16	16	16	16	16	16			
	75,000	144	54.6	18.3	9.85	3.63					3.8	4.0	4.3	4.5	5.0	5.5	6.5	7.5				
8.4	100,000	191	72.8	24.3	13.1	4.83	85	110	135	185	239	16	16	16	16	16	16	16	16			
	150,000	-	-	-	-	-					4.6	4.8	5.1	5.4	5.8	6.4	7.3	8.3				

(NOTE) For speeds not shown on the pump hydraulic charts, consult factory.



GH

PUMP HYDRAULIC SIZE CHART

SEC. 500

Page 55

January 2010

**10 GPM
580 RPM**

NOMINAL		ROTOR TRIM	VISCOSITY (SSU)	N.I.P.R. (PSIA)	FRICTION PIPE LOSS (PSI/FT) <small>(Based on Sch 40 Steel Pipe)</small>					FULL BYPASS RELIEF VALVE PRESSURE (PSI)					CAPACITY (GPM) / H.P. REQUIRED														
CAP. GPM	SPEED RPM				PIPE DIAMETER	CRACKING PRESS. (PSI)		DIFFERENTIAL PRESSURE (PSI)																					
		3/4"	1"	1 1/4"		1 1/2"	2"	LOW PRES R/V		HI PRES R/V		MEDIUM DUTY AND HEAVY DUTY				HEAVY DUTY ONLY													
				50	75	100	150	200	25	50	75	100	150	200	300	400													
10	580	STD	28	1.2	.01	.01	.01	.01	.01	56	81	106						9	8.5	8	7.5								
			32		.08	.03	.01	.01	.01											.25	.41	.59	.73						
			38	1.2	.11	.04	.01	.01	.01	56	81	106	157							9.5	9	8.5	8	7.5					
			50		.13	.04	.01	.01	.01											.29	.45	.63	.80	1.1					
			70	1.2	.14	.05	.02	.01	.01	56	81	107	158	209						10	9.5	9.5	9	8.5	8.5				
			100		.14	.05	.02	.01	.01											.40	.54	.69	.84	1.1	1.4				
			150	1.2	.17	.07	.03	.02	.01	57	82	108	158	211						10	10	10	9.5	9.5	9	9	8		
			200		.30	.12	.04	.02	.01											.45	.58	.73	.88	1.2	1.4	2.0	2.6		
			300	1.2	.39	.15	.05	.02	.01	57	82	109	159	212						11	10	10	10	10	9.5	9.5	9		
			500		.64	.24	.08	.05	.02											.49	.62	.77	.92	1.2	1.5	2.1	2.7		
			750	1.2	.96	.36	.12	.07	.03	57	82	111	161	214						11	11	10	10	10	10	10	9.5		
			1,000		1.28	.49	.16	.09	.03											.54	.66	.82	.97	1.3	1.6	2.2	2.8		
		2,000	1.7	2.55	.97	.33	.18	.07	58	85	112	162	214						11	11	11	10	10	10	10	10			
		3,500		4.46	1.70	.57	.31	.12											.64	.76	.91	1.1	1.4	1.7	2.3	2.9			
		5,000	2.1	6.38	2.43	.81	.44	.16	60	85	112	162	214						11	11	11	11	10	10	10	10			
		7,500		9.57	3.64	1.22	.66	.24											.82	.97	1.1	1.3	1.6	1.9	2.4	3.0			
		10,000	2.5	12.8	4.86	1.62	.88	.32	63	88	114	166	216						11	11	11	11	10	10	10	10			
		15,000		19.2	7.29	2.43	1.31	.49											1.1	1.3	1.4	1.6	1.9	2.2	2.8	3.4			
		20,000	2.9	25.5	9.71	3.24	1.75	.65	66	91	116	168	218						11	11	11	11	10	10	10	10			
		25,000		31.9	12.2	4.05	2.19	.81											1.4	1.5	1.7	1.9	2.2	2.5	3.2	3.9			
		50,000	4.8	63.8	24.3	8.11	4.38	1.61	69	94	122	172	224						11	11	11	11	10	10	10	10			
		75,000		95.7	36.4	12.2	6.56	2.42											2.0	2.2	2.4	2.5	2.9	3.2	3.9	4.6			
		100,000	7.1	128	48.6	16.2	8.75	3.22	73	98	126	176	230						11	11	11	11	10	10	10	10			
		150,000		191	72.9	24.3	13.1	4.83											2.5	2.8	3.0	3.2	3.5	3.9	4.5	5.2			
200,000																													
250,000																													

(NOTE) For speeds not shown on the pump hydraulic charts, consult factory.